

SLOT DİFÜZÖRLER DSL

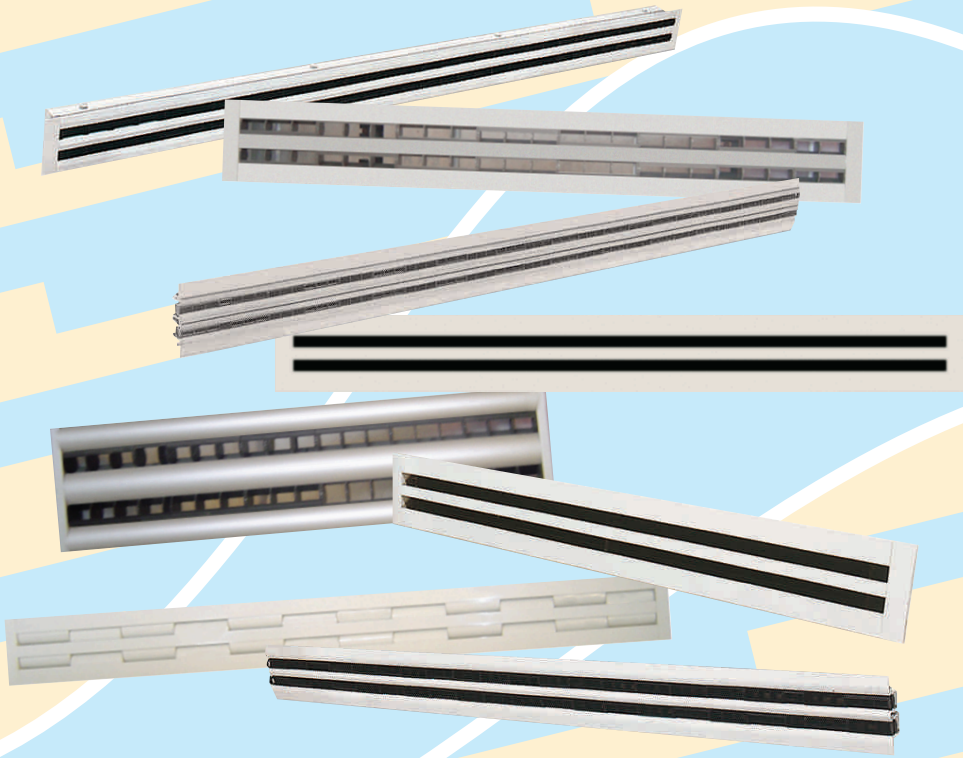

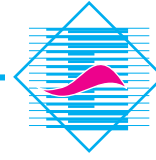

SLOT DİFÜZÖRLER

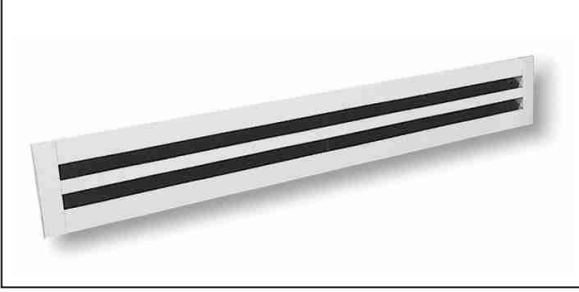

DSL 01

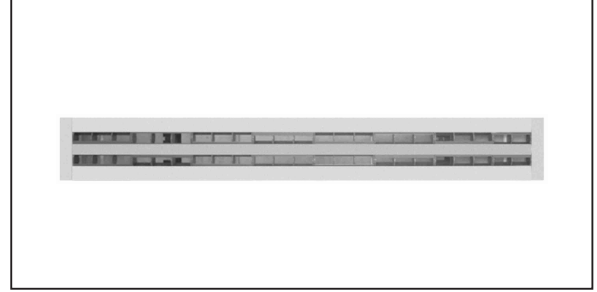

DSL 05

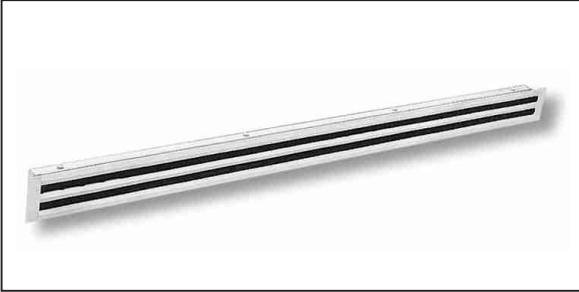

DSL 02

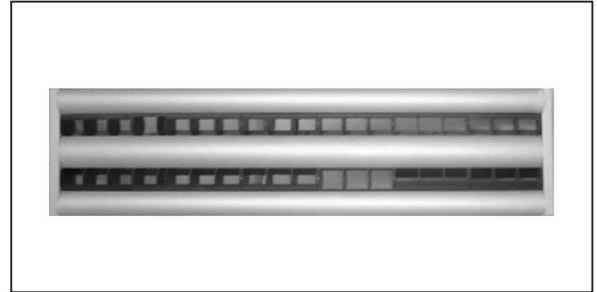

DSL 06

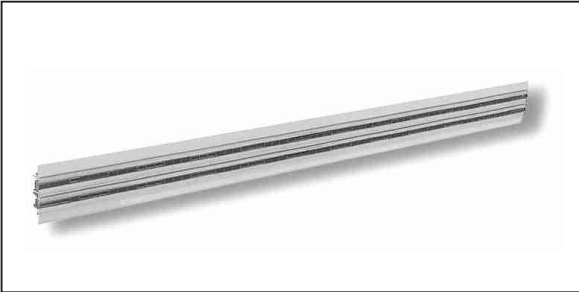

DSL 03

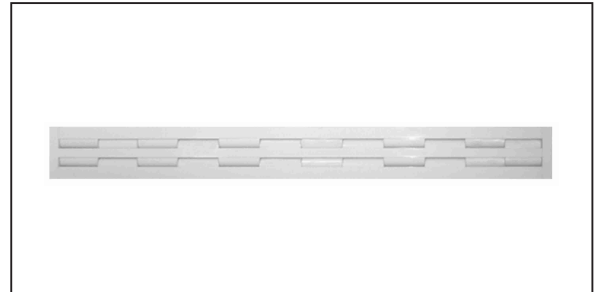

DSL 07

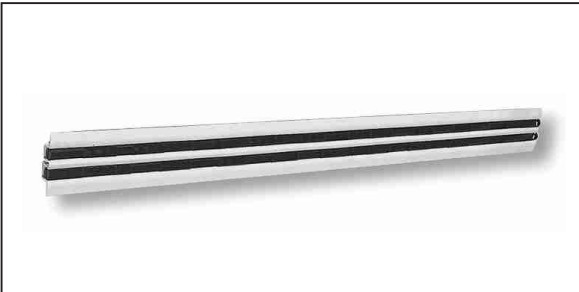

DSL 04



DSL 08

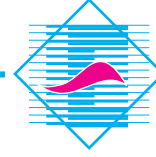

SLOT DİFÜZÖRLER

GENEL BİLGİ

Slot difüzörler, hem teknik hem de estetik ihtiyaçlara cevap verebilecek şekilde dizayn edilirler. Dağıtıcı ve toplayıcı olarak kullanılan bu difüzörler alüminyum profilden imal edilirler. Duvara ve tavana monte edilebilme özelliğine sahiptirler. Bu difüzörler; Aşağıda belirtilen yüksekliğe sahip mekanlarda kullanılmaktadır. Ayarlanabilir kanatlar vasıtasıyla çok çeşitli uygulamalarda kullanmak mümkündür. Havanın dikey yönde yönlendirilmesiyle ısıtma, yatay yönde yönlendirilmesiyle soğutma yapılır. Kanatların ayarlanmasıyla ses seviyesi ve basınç düşümleri sabitlenir. Difüzörler monte edildikten sonra bile, istenilen herhangi bir zamanda, kanat ayarı yapılarak havanın akışı yönlendirilir. Sipariş esnasında, özel bir kanat pozisyonu istenirse, bu pozisyon, fabrikada imalat aşamasında yapılır. Eğer herhangi bir pozisyon belirtilmezse standart olarak ayarlanır. Üfleme hava sıcaklığı Δt_z $-10K$ 'den $+10K$ 'e kadar uygulanmalıdır. DSL serisi 1,2,3,4 slotlu olarak düzenlenebilmektedir.

Slot difüzörlerin kanala montajı plenum box ile birlikte yapılmaktadır. DSL 01-DSL 07 modelimize istenirse damper ilavesi yapılarak monte edilir.

Tüm yüzeyler alüminyum profilden , hava ayar kanatları standart olarak siyah, gri ve beyaz PVC'den , Plenum box ise galvaniz çelikten yapılmaktadır. Ürünlerimiz eloksal, analog ve 9010 elektrostatik fırın boya ile boyanırlar. İsteğe bağlı olarak diğer renkler RAL kataloğundan seçilerek boyanır.

Kullanım yerine göre 3 grupta toplanırlar;

1- DÜŞÜK MEKANLARDA; 2~2,6m arası yüksekliğe sahip mekanlarda

- DSL 01
- DSL 02
- DSL 03
- DSL 04
- DSL 05

2- ORTA MEKANLARDA; 2.6~5m arası yüksekliğe sahip mekanlarda

- DSL 01
- DSL 07
- DSL 08

3- YÜKSEK MEKANLARDA; 5~12m arası yüksekliğe sahip mekanlarda

- DSL 01
- DSL 06

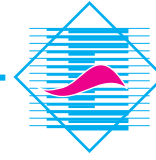

SLOT DİFÜZÖR DSL 07

STANDART ÖLÇÜLER

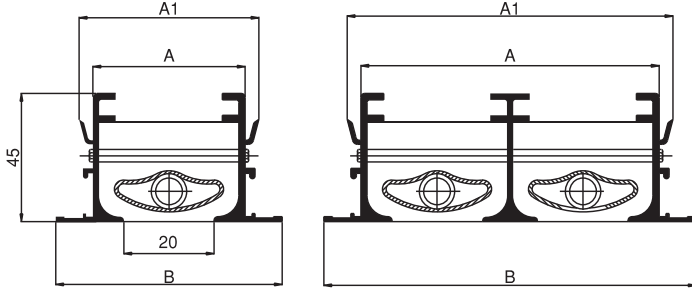

SLOT ÖLÇÜLERİ

	A(mm)	A1(mm)	B(mm)
1 Slot	40	50	76
2 Slot	80	90	115
3 Slot	120	130	155
4 Slot	160	170	195

A-Her iki tarafında yan kapak

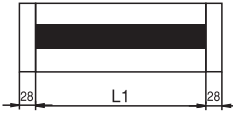

B-Yan kapaksız

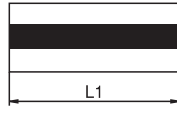

R-Sol tarafında yan kapak

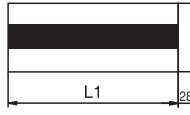

L-Sağ tarafında yan kapak

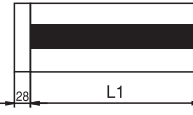

Not: Yan kapak ile ilgili istekler sipariş sırasında belirtilmelidir. Standart olarak, slotların her iki tarafına yan kapakları takılmaktadır.

K 90-90°'lik Köşe Slot

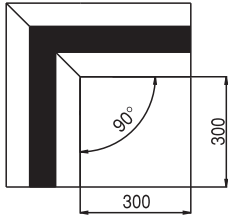

K 135-135°'lik Köşe Slot

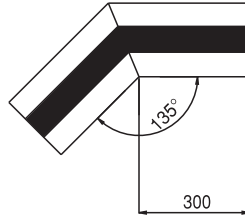

DSL 07

PLENUM BOX ÖLÇÜLERİ

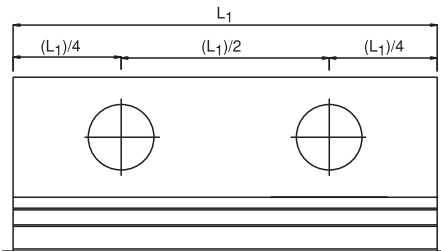

Köprülü Tip Montaj

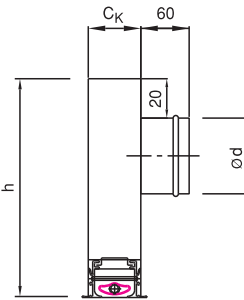

Askılı Tip Montaj

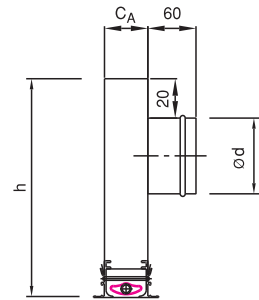

Plenum Box Uzunluğuna Göre Kutu Yükseklikleri ve Boğaz Çapları

L1(mm)	400-1000	1100-1500	400-1500		
Boğaz Sayısı	Tek	İki			
	ØD		h	C _K	C _A
1 Slot	123	123	250	53	43
2 Slot	148	148	250	93	83
3 Slot	198	198	300	133	123
4 Slot	248	248	350	173	163

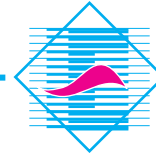

DSL 07

Kanat Pozisyonu

Bir Slot için
Hava Debisi

İki Difüzör Arasındaki
Minimum Mesafe

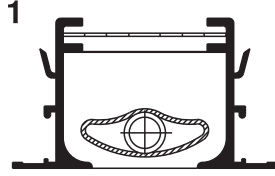

30 m³/h.m

1 m

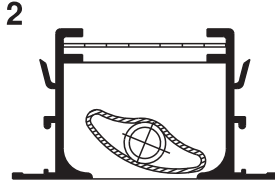

60 m³/h.m

3,5 m

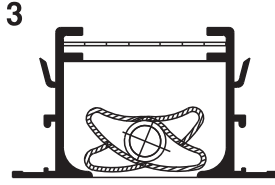

80 m³/h.m

2,5 m

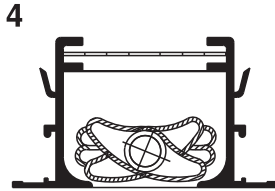

100 m³/h.m

2,5 m

4' nolu Kanat pozisyonu için hızlı seçim tablosu

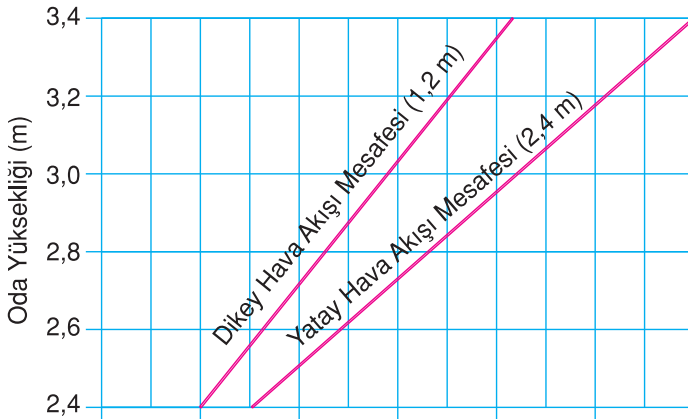

V(m³/h.m) : Metre başına üflenen hava debisi

V(l/s.m) : Metre başına üflenen hava debisi

LWA [dB(A)] : Ses seviyesi

ΔPt(Pa) : Basınç kaybı

20	40	60	80	100	120	140	V(m ³ /h.m)
5,5	11,1	16,7	22,2	27,8	33,3	38,9	V(l/s.m)
-	-	13	21	27	32	36	LWA [dB(A)]
-	-	-	15	24	32	45	ΔPt

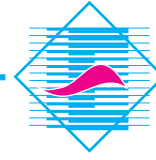

DSL 07

ÜFLEME VE EMİŞ HAVALARI

Üfleme Havası
Ses Seviyesi (Klapeli)

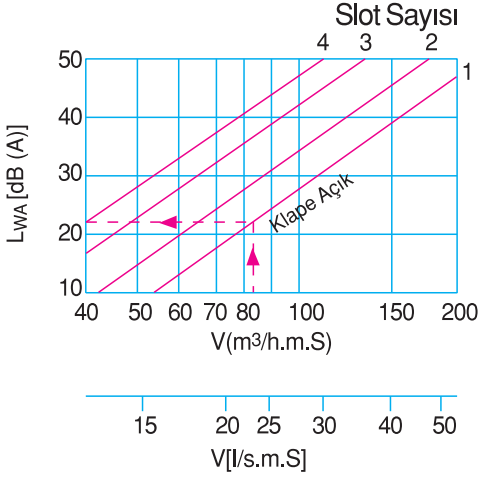

Klapeli "Kapalı" +4 dB (A)

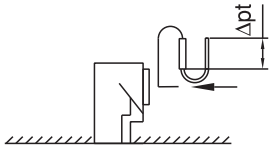

Emiş Havası
Ses Seviyesi (Klapeli)

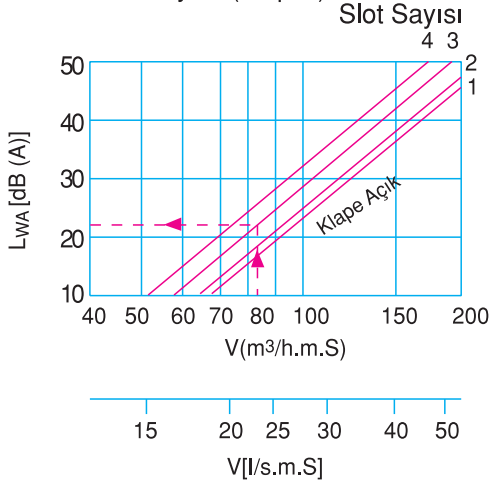

Klapeli "Kapalı" +16 dB (A)

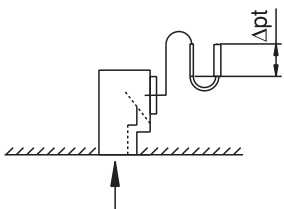

Üfleme Havası
Toplam Basınç Kaybı

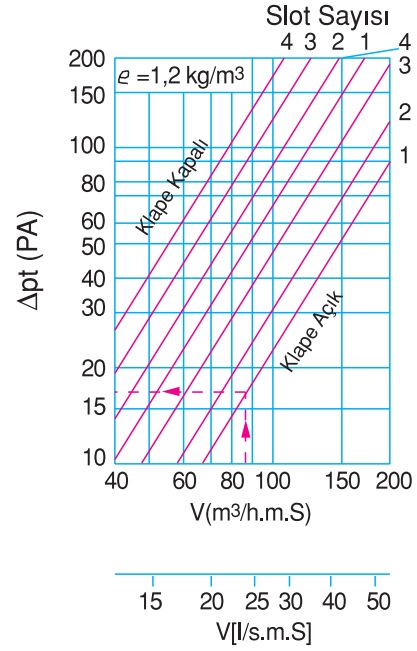

Emiş Havası
Toplam Basınç Kaybı

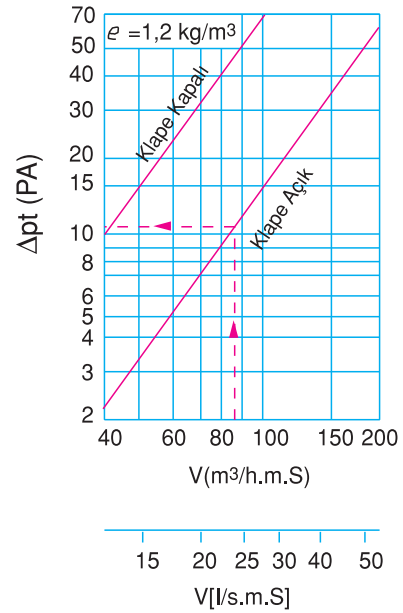

$V(m^3/h.m)$: Metre başına 1 slottaki üflenen hava debisi

$V(l/s.m)$: Metre başına 1 slottaki üflenen hava debisi

$L_{WA} [dB(A)]$: Ses seviyesi

$\Delta Pt(Pa)$: Basınç kaybı

Difüzör Uzunluğu (m)	1	1,5	2	2,5	3	4	5
Düzeltilme faktörü [dB(A)]	0	1,8	3	4	4,7	6	7

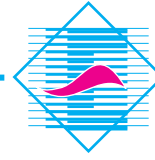

DSL 07

1 Numaralı Kanat Pozisyonuna Göre Hedef Bölgedeki Hava Hızı

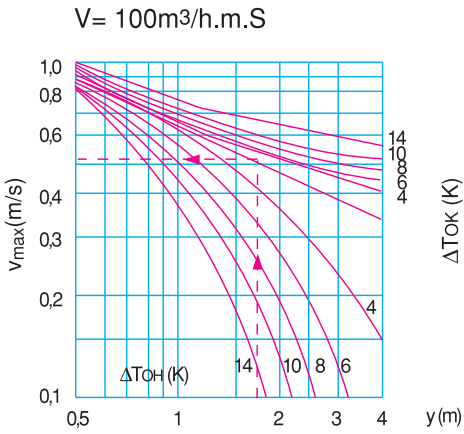
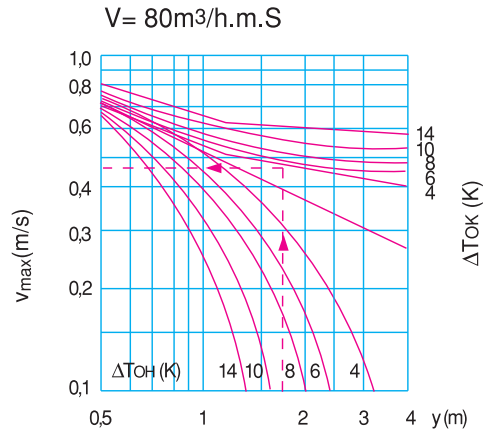
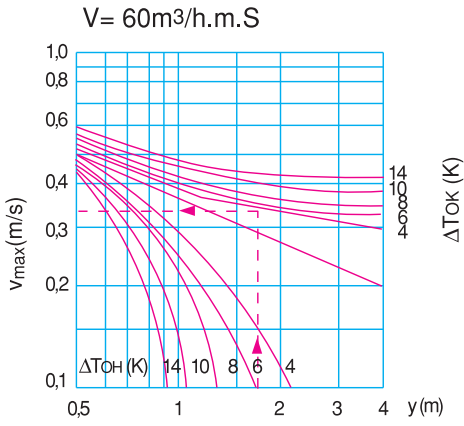
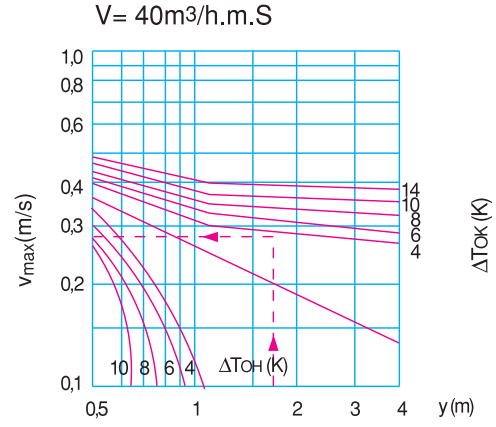
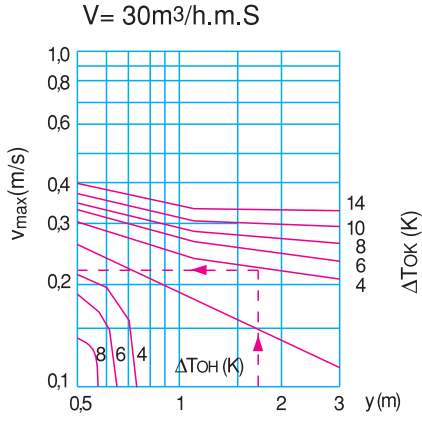

Hedef Bölgedeki Hava Hızı ve Sıcaklık Oranı

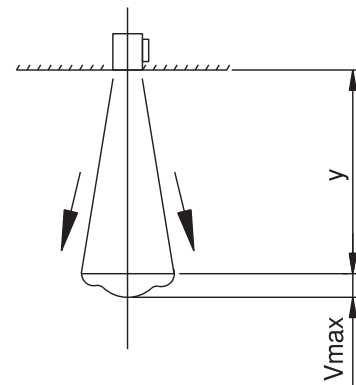

- 1 - slot : x 1
- 2 - slot : x 1,3
- 3 - slot : x 1,6

İndüksiyon ve Sıcaklık Oranı

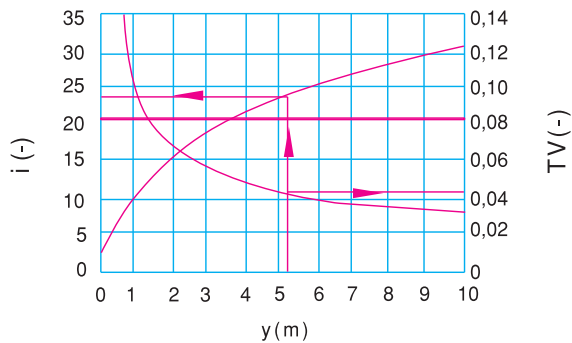

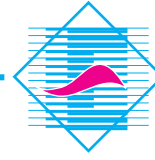

DSL 07

2 Numaralı Kanat Pozisyonu, Tek Yollu Hava Çıkışına Göre Hedef Bölgedeki Hava Hızı

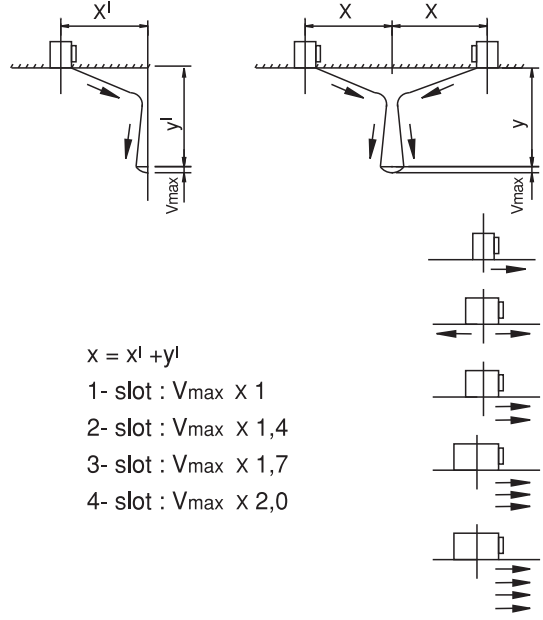
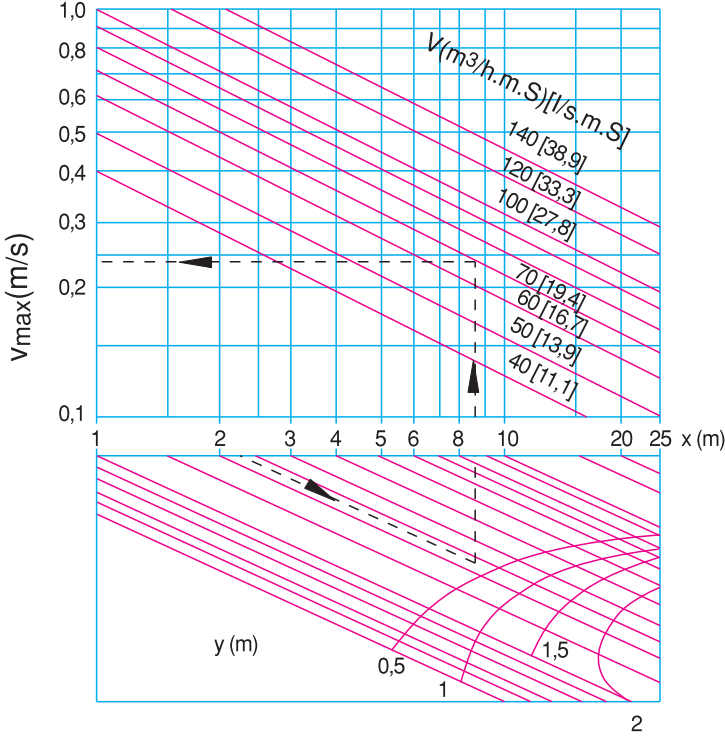

Kritik Akış Hattı

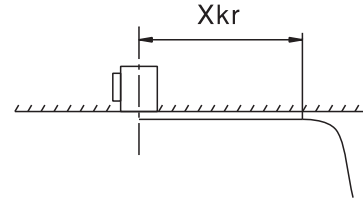
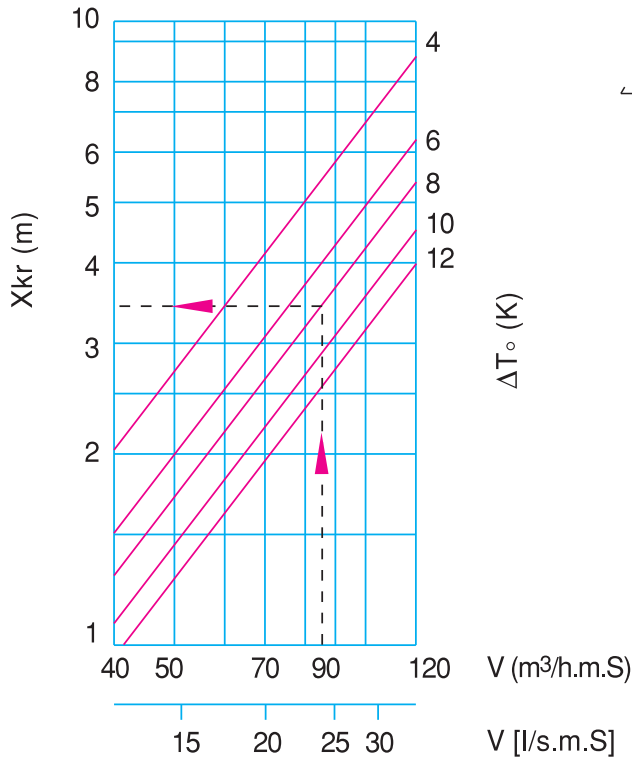

- 1- slot : $X_{kr} \times 1$
2- slot : $X_{kr} \times 1,26$
3- slot : $X_{kr} \times 1,44$
4- slot : $X_{kr} \times 1,64$

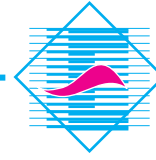

DSL 07

3 Numaralı Kanat Pozisyonu, Çift Yollu Hava Çıkışına Göre Hedef Bölgedeki Hava Hızı

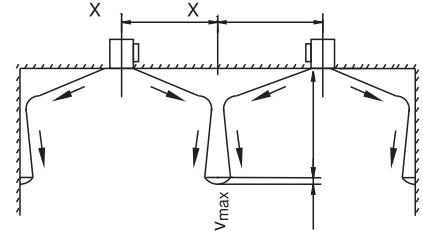
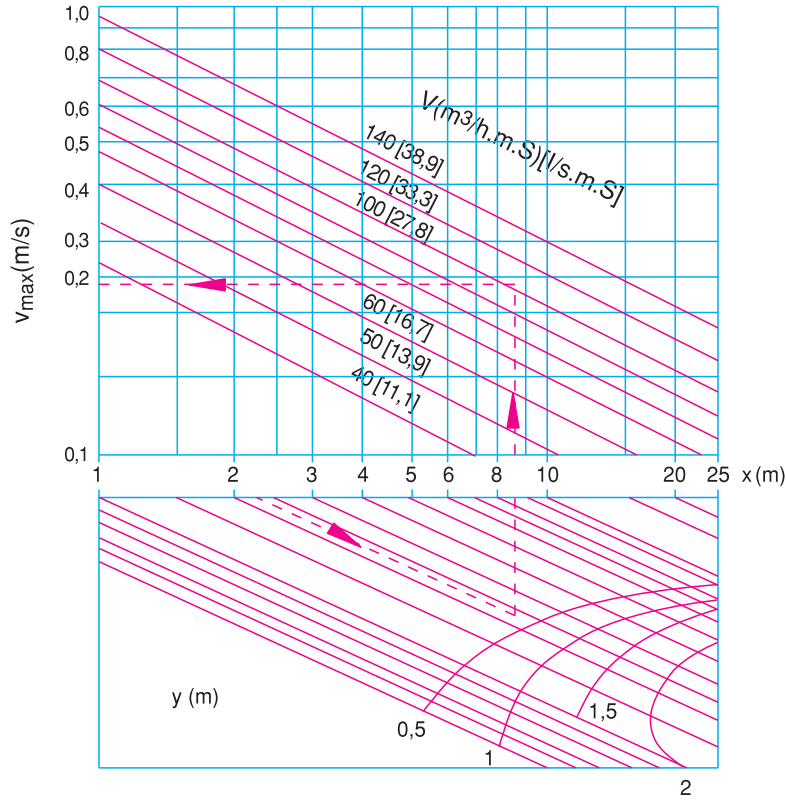

- 1- slot : $v_{max} \times 1$
- 2- slot : $v_{max} \times 1,4$
- 3- slot : $v_{max} \times 1,86$
- 4- slot : $v_{max} \times 2,0$

Sıcaklık Oranı

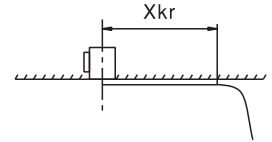
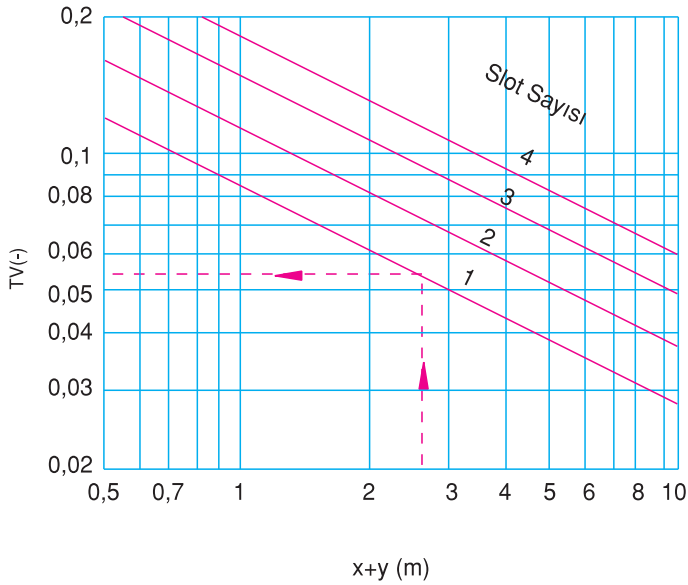

Kritik Akış Hattı

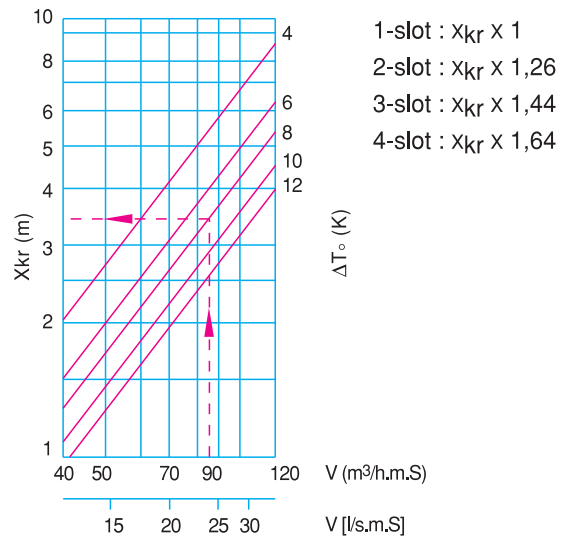

- 1-slot : $X_{kr} \times 1$
- 2-slot : $X_{kr} \times 1,26$
- 3-slot : $X_{kr} \times 1,44$
- 4-slot : $X_{kr} \times 1,64$

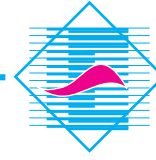

DSL 07

4 Numaralı Kanat Pozisyonu, Dairesel Hava Akımına Göre Hedef Bölgedeki Hava Hızı

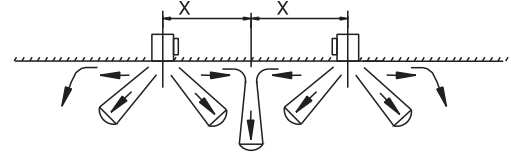
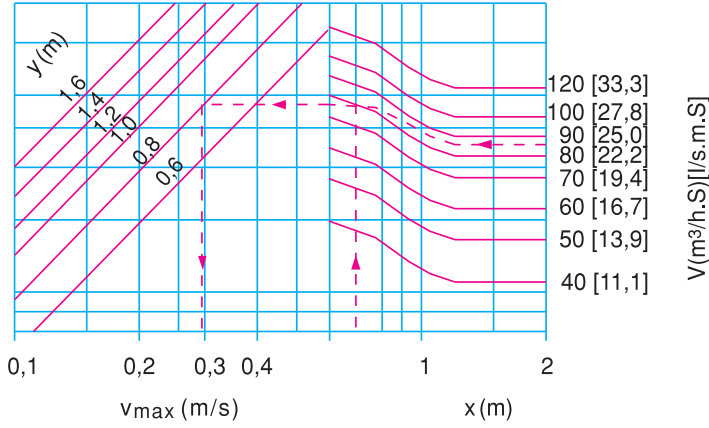

- 1-slot : $v_{max} \times 1$
- 2-slot : $v_{max} \times 1,4$
- 3-slot : $v_{max} \times 1,86$
- 4-slot : $v_{max} \times 2,0$

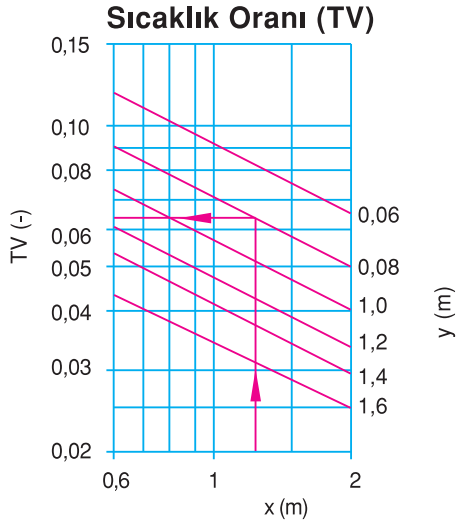

- 1-slot : TV x 1
- 2-slot : TV x 1,4
- 3-slot : TV x 1,7
- 4-slot : TV x 2,0

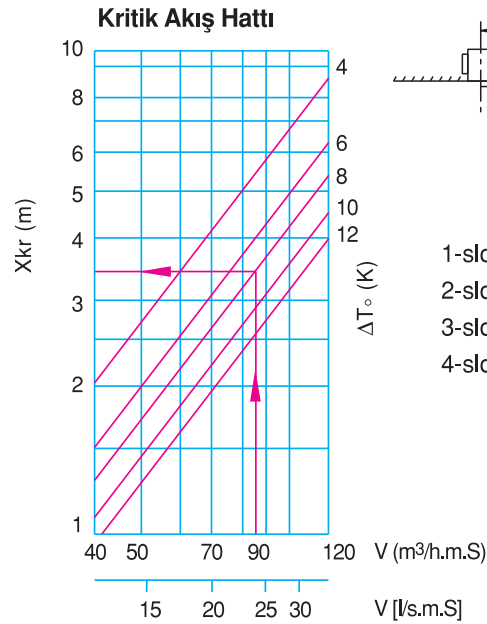

- 1-slot : $X_{kr} \times 1$
- 2-slot : $X_{kr} \times 1,26$
- 3-slot : $X_{kr} \times 1,44$
- 4-slot : $X_{kr} \times 1,64$

Maksimum Yayılma Derinliği (Isıtmada)

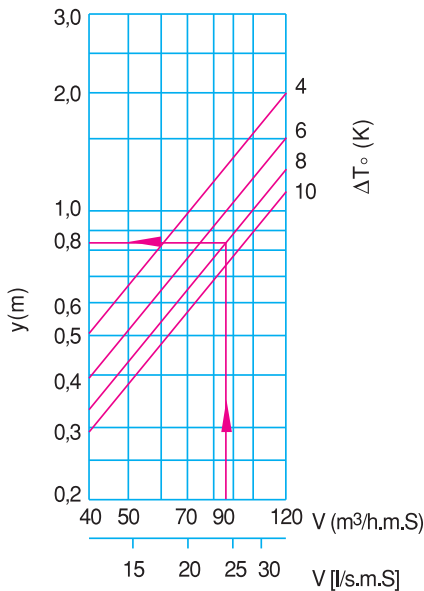

- 1-slot : y x 1
- 2-slot : y x 1,1
- 3-slot : y x 1,2
- 4-slot : y x 1,3

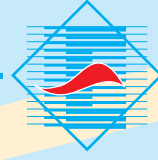

ELEKTROTEKNİK

Klima Sanayi ve Ticaret A.Ş.



Fabrika / Factory - İstanbul

Atatürk Cad. Çağatay Sokak
No:3 Sarıgazi Sancaktepe / İstanbul / TURKEY 34785
Tel / Phone : +90 216 499 14 64 (Pbx)
Faks / Fax : +90 216 499 66 19



Fabrika / Factory - Eskişehir

Eskişehir OSB
Schiller Bulvarı No:29/A Eskişehir / TURKEY
Tel / Phone : +90 222 236 20 40
Faks / Fax : +90 222 236 20 49



Fabrika / Factory - Eskişehir

Eskişehir OSB
Schiller Bulvarı No:29/B Eskişehir / TURKEY
Tel / Phone : +90 222 236 20 40
Faks / Fax : +90 222 236 20 49



Fabrika / Factory - Eskişehir

Eskişehir OSB
Organize San. Bölgesi 21. Cad. No: 15
Tel / Phone : +90 222 236 20 40
Faks / Fax : +90 222 236 20 49

www.elektroteknik.com.tr / info@elektroteknik.com.tr